

Paxton

Net2 plus

DS1038

System specifications

| | |
|--|--------------------------|
| Maximum total users/tokens | 50,000 |
| PIN Length | 4 - 8 |
| Number of codes | 50 |
| Code length | 4 - 8 |
| Number of time zones | 64 |
| Number of access levels | 250 |
| Stored events | 2500+ |
| Data retention during a total power loss | 30 days |
| Handsfree compatible | Yes - requires interface |
| Clock and data | Yes |
| 26 bit Wiegand | Yes (Max 50 bits) |
| Custom Wiegand | Yes (Max 50 bits) |
| Silent operation | Yes |
| Door open time | 1 sec - 5000 secs |

Electrical

| | |
|--------------------------|------------------------------------|
| Operating Voltage | 12VDC \pm 20% or 24VDC \pm 20% |
| Current consumption | 200mA @ 12VDC |
| Relay switchable voltage | 24V DC |
| Relay switchable current | 4A max |
| Alarm output current | 1A |

Communication

| | |
|-------------------------------------|---------------------|
| TCP/IP | Yes |
| Wireless | No |
| RS485 | Yes |
| Ethernet network speed | 100Mbit/s auto MDIX |
| Ethernet bandwidth requirement | 200 kbits/sec |
| DHCP support (fixed IP recommended) | Yes |

Hardware

| | |
|--------------------------------------|--|
| Reader ports per ACU | 2 |
| Readers/Keypads per ACU | 4 - check current draw on individual readers |
| Total ACU reader port output current | 500mA |
| 3rd party reader support | Yes - if compatible |
| Reader cable type | Belden 9540 |
| Network cable type | CAT5 or Belden 8723 |

Features

| | |
|------------------------|-----|
| Input for exit button | Yes |
| Input for door contact | Yes |
| Alarm/bell output | Yes |

Environment

| | |
|-----------------------|---|
| Operating temperature | 0°C - +55°C +32°F - +131°F |
| Moisture resistance | No - if used externally, it must be protected in a weatherproof housing |
| Vandal Resistance | Low |

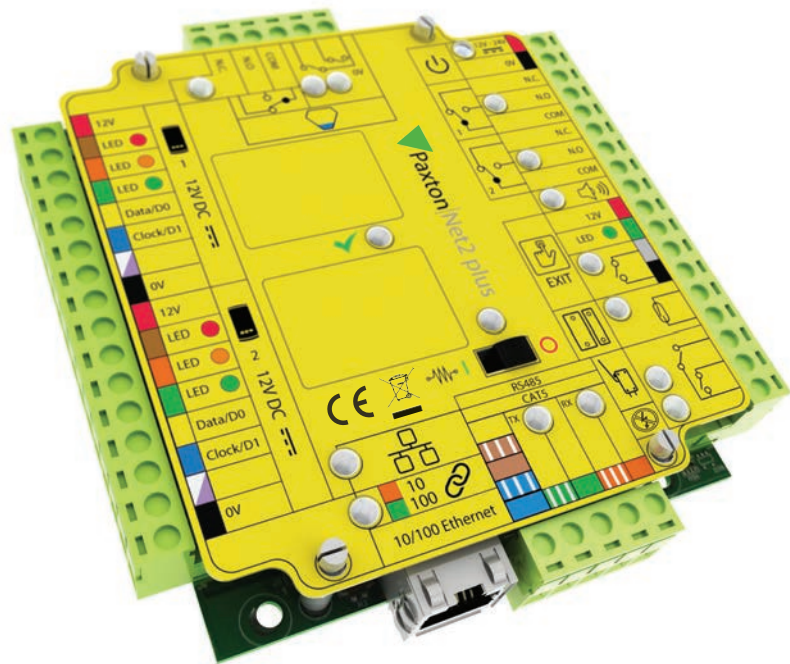

Net2 plus is a single door access control unit and is the most advanced control unit in the Paxton range. Employing the latest technology, it offers huge potential for future expansion and as security technology develops, Net2 plus can take full advantage. Unlike many systems of its type, Net2 plus is truly future-proof. Using Net2 plus ensures that access control is sound investment no matter how the system requirements change.

Net2 plus has on-board TCP/IP to allow direct connection to a computer network. This can save time, money and result in a better, more resilient system. Net2 plus control units can also be connected together using a dedicated RS485 network. This reduces the number of TCP/IP network points required for larger systems.

As with all Net2 control units, Net2 plus is designed to work seamlessly in the event of communications failure. It will continue to permit or deny access to users as appropriate. Once communications are re-established the activity is reported back to the PC.

Other hardware features:

- Volt free control relay
- Input for PSU fail
- Input for tamper
- Integrated termination resistors
- Dedicated intruder alarm

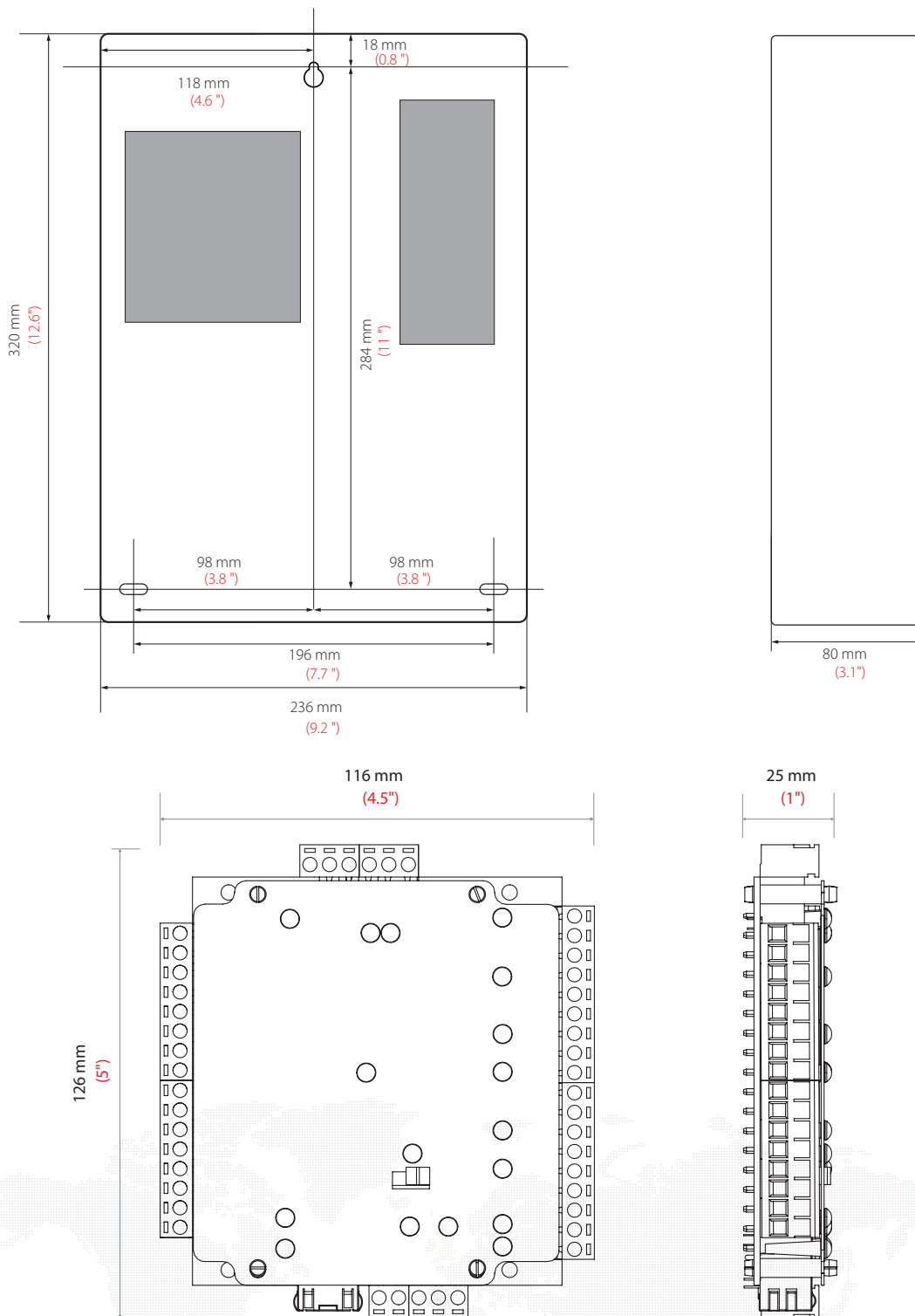

Accessories and sales codes

| | | | |
|---|---------|---|---------|
| Net2 Plus 1 door controller | 682-493 | Net2 Plus 1 door controller - Plastic housing | 682-528 |
| Net2 Plus 1 door controller - 12V 2A PSU, Plastic cabinet | 682-531 | Net2 Plus 1 door controller - 12V 2A PSU, Metal cabinet | 682-813 |
| Net2 Plus 1 door controller - PoE+, Plastic cabinet | 682-284 | Net2 Plus 1 door controller - PoE+, Metal cabinet | 682-721 |